



Annual Report 2020-2021

**Nawab Siraj-Ud-Dowla Govt. College,
Natore**



Professor Md. Zahirul Islam
Principal
Nawab Siraj-Ud- Dowla Govt. College,
Natore.

Message

A reputed institution of education in the northern region as well as in the country, Nawab Siraj-Ud-Dowla Government College is situated within a little distance of **Uttara Ganabhaban**, in Jibananda Das' Banalata Sen's Natore, which is washed clean by the greatest Chalan Beel and rivers such as the Attrai, the Narad and the Barnan. We are proud that in the country it is the only College named after the name Nawab Sirj-Ud-Dowla, the last independent Nawab of undivided Bengal. Since its founding in 1956 the College has been providing the light of education to innumerable students. At present it is a co-educational institution of higher education with Honours and Masters along with H.S.C and Degree (Pass) levels with almost thirteen thousand students. The college is continuing academic activities with 62 teachers (out of 73) skilled teachers and 0000 office employees. Huge number of students comes out of the college every year with brilliant results. In performance rank of the Board and National University, the college has fairly a good position. They teachers have been trying untiringly to teach the students by suitable methods in the light of curriculum and co-curriculum activities with special emphasis on ICT. The college has been endeavouring to ensure quality education by creating favourable atmosphere and building infrastructures so that the students can be fit to meet the challenges of the modern time and contribute to the building of Banga Bhandhu's 'Sonar Bangla.

During Covid 19 pandemic situation the college authority has taken steps to arrange online class to keep the students involved in learning at home.

The College is duly implementing IDP of IDG program under CEDP of Ministry of Education with the cooperation of the IDP Implementation Team to maximize sustainable utilities of the program for the interest of the institution.

The Annual Report 2020-2021 is prepared primarily for the students, faculty, administrators, and advisors as well as the common people. It is intended to clearly outline its work, plan, vision and mission to accomplish its goals and objectives.

We do hope and believe that Nawab Siraj-Ud- Dowla Government College will be an ideal institution of education of international level in Bangladesh.

| Contents | | Page No |
|--|---|-----------|
| Chapter – 1 : Introduction | | 1 |
| | Brief History | 1 |
| | Location | 1 |
| | Superstructure | 3 |
| | Vision | 5 |
| | Mission | 5 |
| | Purpose and Structure: | 5 |
| Chapter 2: Overview of the College (Institutional and Academic) | | 6 |
| | 2.1: Governance and Teaching Structure | 6 |
| | 2.2: List of Department and others Academic Programs | 7 |
| | 2.3: Number of Students in Master’s Courses by Subjects in 2019 | 8 |
| | 2.4: Key Academic Statistics: | 9 |
| | 2.5: Infrastructure and Facility Profile of the College | 10 |
| Chapter -3: Highlight of the Year | | 11 |
| | 3.1 Key Achievements and Highlights of the Year of the College | 11 |
| | 3.2 Key Achievements and Highlights of the Year of the Departments | 12 |
| | 3.3 Key Achievements and Highlights of the year of Institutional Development Grants (IDG) | 13 |
| Chapter -4: Teacher Development | | 13 |
| | 4.1: Overview of Teaching Force of the College | 13 |
| | 4.2: Teacher Professional Development Programs | 14 |
| | 4.3: Highlights of Teacher Development Activities of the Year | 14 |
| Chapter -5: Budget and Finance. | | 15 |
| | 5.1: Summary of Annual Budget and Expenditures | 15 |
| | 5.2: Status of Annual Audits | 17 |
| Chapter -6: Concluding Remarks. | | 18 |
| | 6.1: Overall Assessment of performance of the Last Year and Key Targets for the Next Year | 18 |
| | 6.2: Key Challenges and Risks for the College | 19 |
| | 6.3: Recommendations | 19 |
| Chapter -7: Photo Gallery. | | 20 |

Chapter 1: Introduction

Brief History

Nawab Siraj-Ud- Dowla Government College is a renowned institution of higher education though it started its journey as a private institution. The college was founded on 1st July 1956, as Natore College with an aim to provide education to the students coming from different remote parts of the district, then called sub-division. The college was renamed as " Nawab Siraj-Ud- Dowla College" in 1959. On 1st March, 1980, it was nationalized by the then Government. It is a co-educational institution. For more than six decades, the institution has gradually enriched its traditions and produced innumerable worthy students who have served and are still serving in different significant positions of the state and society. At present it is an institution of higher education with Honours in thirteen disciplines and Masters in ten disciplines along with H.S.C and Degree (Pass) levels with almost thirteen thousand students. Seventy Three teachers and office staff of 73 members are working hard to further the ongoing progress of the college.

Location:

The College stands in an atmosphere of nature's soothing bounteous beauty on the old Natore-Rajshahi road at the locality called Bargach, adjacent to the town of Natore, about a quarter kilo metre from Natore Railway station. It is situated on two campuses (connected by a passage) of about 11 acres of land. Besides the main campus, the college has about 25 acres of agricultural land in Jokadaha, Lalpur Upozila, Natore. The campuses are surrounded by boundary walls. There is a spacious playground for the students and two spectacular ponds with rows of myriad trees on the sides. The river Narad divides the main campus into two parts which are joined by a small bridge.

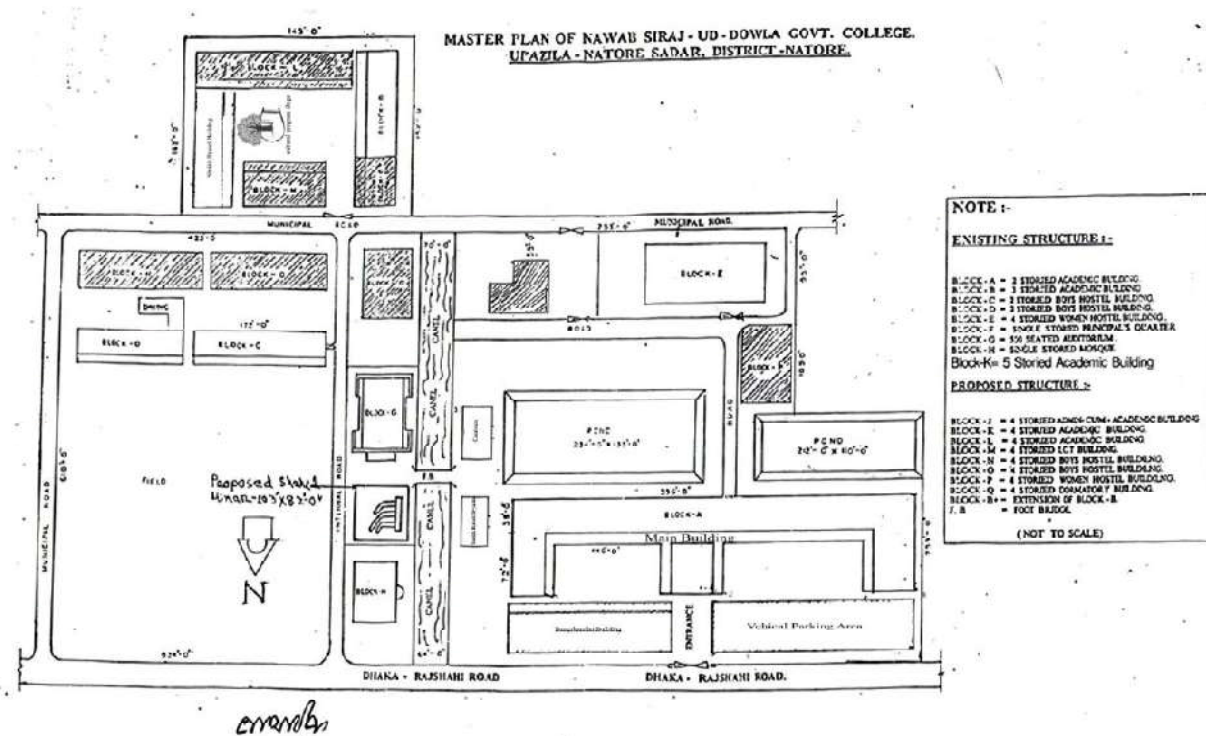

Superstructure:

In the main campus, there is a two-storeyed long and E-shaped Building called Main Bhaban used for Administrative unit and academic purpose. There is another academic building of five storeys called Bangabandhu Bhaban. Science Bhaban stands on the second campus where there are two buildings- one three-storeyed and the other five-storeyed, called Sheikh Rashel Science Building. Besides, there is a big Auditorium with modern facilities, a mosque and two hostels- one for the male students and the other for the girls-on the main campus.



Main Bhaban



Bangabandhu Bhaban



Science Bhaban



Sheikh Rashel Science Bhaban



Auditorium



Mosque



Female Hostel



Male Hostel

Vision

The college is moving on with its vision of ensuring quality education for the students in order that they can be good citizens and successfully face challenges in the national and global perspective in the realization of the Government's VISION 2041.

Mission

The College has taken the Governments VISION 2041 as its mission. It is trying to the best of its ability to achieve the target of Digital Bangladesh and Prosperous Bangladesh by making the best use of its limited resources and man power.

Purpose and Structure:

The report is intended to illustrate a brief and vivid picture of the institution and highlight the major activities accomplished during the fiscal year 2020-2021.

The report contains the following five chapters:

Chapter -1 Introduction

Chapter -2 Overview of the College (Institutional and Academic)

Chapter -3 Highlight of the Year

Chapter -4 Teacher Development

Chapter -5 Budget and Finance.

Chapter -6 Concluding Remarks.

Chapter -7 Photo Gallery.

Chapter 2: Overview of the College (Institutional and Academic)

2.1: Governance and Teaching Structure

Nawab Siraj-Ud- Dowla Govt. College is a government educational institution. The administrative structure of the college is below.

| |
|---|
| Ministry of Education |
| Directorate of Secondary and Higher Education |
| Division |
| Principal |
| Vice Principal |
| Professor |
| Associate Professor |
| Assistant Professor |
| Lecturer |
| Demonstrators |
| Head Clark |
| Accountant |
| Lab Technician |
| M.L.S.S |

2.2: List of Department and others Academic Programs

| Sl. No | Subjects | Annual intake capacity | No. of Student Enrollment (year-wise) | | | | | |
|--------------|---------------------------|------------------------|---------------------------------------|-----------------|-----------------|-----------------|-------|----------------|
| | | | 1 st | 2 nd | 3 rd | 4 th | Total | Total Teachers |
| 1 | Bengali | 145 | 145 | 140 | 130 | 125 | 540 | 04 |
| 2 | English | 100 | 100 | 98 | 90 | 86 | 474 | 04 |
| 3 | Economics | 160 | 160 | 150 | 145 | 142 | 597 | 06 |
| 4 | Political Science | 160 | 160 | 145 | 144 | 135 | 584 | 06 |
| 5 | Islamic History & Culture | 200 | 200 | 189 | 180 | 176 | 745 | 05 |
| 6 | Philosophy | 135 | 135 | 130 | 127 | 120 | 512 | 06 |
| 7 | Physics | 75 | 75 | 70 | 66 | 62 | 273 | 04 |
| 8 | Chemistry | 65 | 65 | 60 | 60 | 56 | 271 | 03 |
| 9 | Botany | 105 | 105 | 100 | 86 | 78 | 369 | 03 |
| 10 | Zoology | 160 | 160 | 155 | 152 | 145 | 612 | 04 |
| 11 | Mathematics | 95 | 95 | 89 | 85 | 81 | 350 | 04 |
| 12 | Accounting | 230 | 228 | 220 | 200 | 195 | 843 | 06 |
| 13 | Management | 230 | 230 | 222 | 210 | 198 | 860 | 05 |
| Total | | 1860 | 1858 | 1768 | 1675 | 1599 | 7030 | 60 |

2.3: Number of Students in Master's Courses by Subjects in 2019

| Sl. No. | Subjects | Annual intake capacity | | No. of Student Enrollment in Preliminary | | No. of Student Enrollment in Masters Final Year | | Total | |
|---------|---------------------------|------------------------|--------------------|--|--------|---|--------|-------|--------|
| | | Preliminary | Masters Final Year | Male | Female | Male | Female | Male | Female |
| 1 | Bengali | - | 100 | - | - | 58 | 42 | 58 | 42 |
| 2 | English | - | 50 | - | - | 31 | 19 | 31 | 19 |
| 3 | Economics | - | 100 | - | - | 55 | 45 | 55 | 45 |
| 4 | Political Science | - | 150 | - | - | 99 | 51 | 99 | 51 |
| 5 | Islamic History & Culture | - | 150 | - | - | 90 | 60 | 90 | 60 |
| 6 | Philosophy | - | 100 | - | - | 55 | 45 | 55 | 45 |
| 7 | Zoology | - | 100 | - | - | 62 | 38 | 62 | 38 |
| 8 | Mathematics | - | 50 | - | - | 40 | 10 | 40 | 10 |
| 9 | Accounting | - | 150 | - | - | 82 | 68 | 82 | 68 |
| 10 | Management | - | 150 | - | - | 90 | 60 | 90 | 60 |
| Total = | | - | 1100 | | - | - | 438 | 662 | 438 |

2.4: Key Academic Statistics:

| Sl. No. | Subject | No. of students attended in the final exam of the honors | | | No. of pass out students | | | Pass rate (%) of students | Total no. of dropout students | % dropout rate |
|---------|---------------------------|--|--------|-------|--------------------------|--------|-------|---------------------------|-------------------------------|----------------|
| | | Male | Female | Total | Male | Female | Total | | | |
| 1 | Bengali | 65 | 45 | 110 | 60 | 30 | 90 | 81.81 | 2 | 1.81 |
| 2 | English | 19 | 46 | 65 | 30 | 20 | 50 | 76.92 | 4 | 6.15 |
| 3 | Economics | 32 | 61 | 93 | 45 | 28 | 73 | 78.49 | 4 | 4.30 |
| 4 | Political Science | 95 | 45 | 140 | 80 | 45 | 125 | 89.28 | 3 | 2.14 |
| 5 | Islamic History & Culture | 75 | 39 | 114 | 55 | 41 | 96 | 84.21 | 2 | 1.75 |
| 6 | Philosophy | 79 | 48 | 126 | 50 | 45 | 95 | 75.39 | 3 | 2.38 |
| 7 | Physics | 20 | 12 | 32 | 18 | 7 | 25 | 78.12 | 5 | 15.62 |
| 8 | Chemistry | 27 | 15 | 42 | 20 | 17 | 37 | 88.09 | 4 | 9.52 |
| 9 | Botany | 30 | 15 | 45 | 19 | 17 | 36 | 80.00 | 2 | 4.44 |
| 10 | Zoology | 60 | 32 | 92 | 66 | 20 | 86 | 93.47 | 2 | 2.17 |
| 11 | Mathematics | 21 | 8 | 29 | 12 | 9 | 21 | 72.41 | 5 | 17.24 |
| 12 | Accounting | 80 | 52 | 132 | 80 | 38 | 118 | 89.39 | 4 | 3.03 |
| 13 | Management | 85 | 56 | 141 | 75 | 29 | 104 | 73.75 | 3 | 2.12 |

2.5: Infrastructure and Facility Profile of the College: There are about 13000 students studying in this college. The college has following infrastructure and others facilities.

2.5.1: Physical Facility

| Sl. No. | Particulars | Number/ |
|---------|---|-------------------------------|
| 1 | The number of rooms devoted to administration, including Principal's Office | 04 |
| 2 | The number of classrooms | 35 |
| 3 | The number of science laboratories | 06 |
| 4 | Auditorium | 01 |
| 5 | The number of computer laboratories | 02 |
| 7 | The number of libraries | Central-01 Seminar-13 |
| 8 | The numbers of Teachers Rooms | Central- 01 Departments-14 |
| 9 | The number of Female Dormitory | 01 |
| 10 | Hostel capacity for girls | 100 |
| 11 | The number of Male Dormitory | 01 |
| 12 | Hostel capacity for boys | 100 |
| 13 | Number of washrooms/toilets in the college | 30 |
| 14 | The number of washrooms/toilets for girls | 05 |
| 15 | Condition of washrooms/toilets toilet [very good, good, somewhat poor, very poor] | good |
| 16 | Condition of electricity supply [very stable/ mostly stable/ somewhat | very stable |

| | | |
|----|--|----------------------|
| | unstable/ unstable/ very limited] | |
| 17 | Whether own generator for power back up exists [Yes/No] | Yes |
| 18 | Number of functional Computers for students | 32 |
| 19 | Number of functional Computers for administrators and teachers | 20 |
| 20 | Number of Printers | 08 |
| 21 | Number of Photocopiers | 02 |
| 22 | Number of Multimedia Projectors | 10 |
| 23 | Motor Vehicle | Bus-1 Micro-bus-2 |

2.5.2 Internet Facility:

| Sl. No. | Particulars | |
|---------|---|-----------------------|
| 1 | Availability of Internet access for teachers [Yes/No] | Yes |
| 2 | Availability of Internet access for students [Yes/No] | Yes |
| 3 | Capacity of Internet connectivity [in Mbps] | 25 |
| 4 | Coverage of Internet on campus [only in computer labs/ computer labs and classrooms/ wifi for anywhere in campus] | only in computer labs |
| 5 | Name of of Internet service Provider | Link3 & BTCL |

Chapter 3: Highlights of the Year

3.1 Key Achievements and Highlights of the Year of the College

In compliance with the traditional reputation as to the different aspects of the previous years, the fiscal year 2019-2020 also stand out with some distinctions for Nawab Siraj-Ud- Dowla Government College. The students of the college showed their academic distinction in examination and in co-curricular activities.

Academic:

- Ranked 6th position in Rajshahi Division based on KPI indicator-2016 of National University.
- Ranked 10th position in Rajshahi Division based on KPI indicator-2017 of National University.
- Examination results: 90% participation in the final exam with pass rate of 80.34%
- Term Papers: 90% participation in submitting the term papers
- Tutorial Exam: 93% participation in submitting the tutorial exam
- Attendance: 75%
- Classroom Performance: The classroom performance has been improved by the use of modern teaching-learning equipment to some extent.
- Online Classes: Due to COVID-19 pandemic situation, the online classes was started and carried forward.

Co-curricular activities:

Following co-curricular activities were performed by the college and its students throughout the year:

- Annual Indoor and outdoor Games Competition: Could not be arranged due to Covid-19 situation.
- Cultural Activities: Could not be arranged due to Covid-19 situation.
- Social Activities: The ‘Badhaon’ arranged a blood donation camp in the last year. The BNCC unit took part to maintain discipline activities and march-past during the celebration of National days.

3.2 Key Achievements and Highlights of the Year of the Departments

Due to COVID-19 situation, the departments continued their academic activities through virtual platform.

3.3 Key Achievements and Highlights of the year of Institutional Development Grants (IDG)

| Sl. No | Package No | Package Description | Method of Procurement (OTM/RFQ) | Estimated Cost TK. In Lac | Contract Price In Tk. | Status |
|--------|------------|--|---------------------------------|---------------------------|-----------------------|-----------|
| 1 | G-1 | Furniture & Fixtures for IDG Office | RFQ | 2 | 1,92,650/- | completed |
| 2 | G-2 | Computer, IT equipments and other accessories for the project office | RFQ | 4.94 | 4,87,000/- | completed |

Chapter 4: Teacher Development

4.1: Overview of Teaching Force of the College:

A total number of 5 teachers have Ph. D. Degree. In the college, there are 73 posts and at present 63 teachers are teaching. 10 posts are lying vacant. An overview of the teaching force of the college is as follows:

Subject wise number of Teachers, Gender and Educational Qualifications

| Sl. No | Subject | Sanctioned posts | Regular | | Contractual | | Part-time | | Total | | Ph. D. Holder | |
|--------|-----------|------------------|---------|--------|-------------|--------|-----------|--------|-------|--------|---------------|--------|
| | | | Male | Female | Male | Female | Male | Female | Male | Female | Male | Female |
| 1 | Bengali | 6 | 4 | 1 | | | | | | | 1 | 0 |
| 2 | English | 6 | 5 | 0 | | | | | | | 0 | 0 |
| 3 | Economics | 6 | 6 | 0 | | | | | | | 0 | 0 |

| | | | | | | | | | | | | |
|-------|---------------------------|----|----|---|--|--|--|--|--|--|---|---|
| 4 | Political Science | 6 | 3 | 2 | | | | | | | 1 | 0 |
| 5 | Islamic History & Culture | 6 | 6 | 0 | | | | | | | 0 | 0 |
| 6 | Philosophy | 6 | 3 | 0 | | | | | | | 0 | 0 |
| 7 | Physics | 5 | 4 | 0 | | | | | | | 1 | 0 |
| 8 | Chemistry | 4 | 2 | 0 | | | | | | | 1 | 0 |
| 9 | Botany | 5 | 3 | 1 | | | | | | | 0 | 0 |
| 10 | Zoology | 6 | 1 | 3 | | | | | | | 0 | 0 |
| 11 | Mathematics | 5 | 1 | 0 | | | | | | | 0 | 0 |
| 12 | Accounting | 6 | 5 | 0 | | | | | | | 0 | 0 |
| 13 | Management | 6 | 5 | 0 | | | | | | | 1 | 0 |
| Total | | 73 | 47 | 7 | | | | | | | 5 | 0 |

4.2: Teacher Professional Development Programs

A large number of teachers participated in various training programs offered by the Ministry of Education, DSHE and National University. A good number of teachers have ICT training and they are contributing their gained knowledge to the students.

4.3: Highlights of Teacher Development Activities of the Year

During the afore-mentioned fiscal year, some teachers contributed research article to the journal published by university and teaching institution of the country. In the pandemic situation, teachers showed their expertise in conducting online classes.

Chapter 5: Budget and Finance

5.1: Summary of Annual Budget and Expenditures

Descriptions of total allocation & expenditure of the fiscal year 2019-20 are given below:

| Financial Code | Salary & Allowances | Allocation | Expenditure |
|----------------|--|-------------|-------------|
| 31 | Rewards of Staffs | | |
| 3111101 | Basic Salary of the officers | 31270000.00 | 29961000.00 |
| 3111201 | Basic Salary of the staffs | 2675000.00 | 2546520.00 |
| 3111302 | Travel Allowance | 250000.00 | 122585.00 |
| 3111306 | Education Allowance | 306000.00 | 246000.00 |
| 3111310 | Housing Rent Allowance | 13260000.00 | 12167394.00 |
| 3111311 | Medical Allowance | 1278000.00 | 1276000.00 |
| 3111312 | Telephone Allowance | | |
| 3111314 | Tiffin Allowance | 27000.00 | 26400.00 |
| 3111316 | Washing Allowance | 800000.00 | 6000.00 |
| 3111325 | Festival Allowance | 5026000.00 | 5829900.00 |
| 3111328 | Rest and Recreation Allowance | 1096000.00 | 907550.00 |
| 3111335 | Bangla New Year Allowance | 565000.00 | 563060.00 |
| 3111338 | Other Allowance | - | |
| 32 | Use of Goods & Services (Administrative Expenditures) | - | |
| 3211113 | Electricity | 500000.00 | 308886.00 |
| 3211117 | Internet/Telex/Fax | 100000.00 | 82090.00 |
| 3211119 | Postal | - | |

| | | | |
|----------------|--|------------|------------|
| 3211120 | Telephone | 25000.00 | 16800.00 |
| 3211127 | Books and Magazines | 230000.00 | 229821.00 |
| 3243101 | Internal Travel Allowance (Travel & Transfer) | - | |
| 3255101 | Computer Accessories (Printing & Stationaries) | 100000.00 | 100000.00 |
| 3255105 | Other Stationaries (Printing & Stationaries) | 180000.00 | 180000.00 |
| 3256102 | Chemicals | 370000.00 | 370000.00 |
| 3256103 | Usable Articles | 140000.00 | 139997.00 |
| 3256106 | Dress (Materials) | 50000.00 | 50000.00 |
| 3256107 | Sports Items | 130000.00 | 130000.00 |
| 3257301 | Festivals | 65000.00 | 65000.00 |
| 3258103 | Computer (Repairing and Maintenance) | 90000.00 | 90000.00 |
| 38 | Other Expenditures | - | |
| 3821101 | Land Development Tax | 25000.00 | 20740.00 |
| 3221103 | Urban Tax | 1500000.00 | 1242790.00 |
| 41 | Financial Assets (Capital Expenditures) | | |
| 4112306 | Laboratory Equipment's | 540000.00 | 539968.00 |
| 4112312 | Education and Educational Materials | 120000.00 | 120000.00 |

5.2: Status of Annual Audits

Information about budget and financial status in last three years (2015-2018)

| Year | Non-development fund received | Development fund received | Source of budget allocation (Gov./Private Donation) | Revenue earned by the college (Tuition fee/ rent/service) | Amount of annual expenditures | Amount of bank balance |
|---------|-------------------------------|---------------------------|---|---|-------------------------------|------------------------|
| 2015-16 | 3,41,39,000 | | Gov. | | 3,39,98,000 | |
| 2016-17 | 4,76,03,000 | | Gov. | | 4,73,42,500 | |
| 2017-18 | 5,34,30,000 | | Gov. | | 5,30,44,700 | |
| | | | | | | |

: Summary of Annual Revenues (Including Students tuition and fees and other income generation):

Table-1

| Class/Year | Session | No. of Students (Tuition & Admission Fees) | Total |
|--------------------------|-----------|--|-----------|
| HSC 2 nd Year | 2019-2020 | 1200×260 | 312000.00 |
| HSC 1 st Year | 2020-2021 | 1200×260 | 312000.00 |
| Total | | | 624000.00 |

Table-2

| Class/Year | Session | No. of Students (Tuition & Admission Fees) | Total |
|----------------------------------|-----------|--|-----------|
| Degree Pass 1 st Year | 2018-2019 | 406×325 | 131950.00 |
| Degree Pass 2 nd Year | 2019-2020 | 289×325 | 93925.00 |
| Degree Pass 3 rd Year | 2020-2021 | 256×325 | 83200.00 |
| Total | | | 309075.00 |

Table-3

| Class/Year | Session | No. of Students (Tuition & Admission Fees) | Total |
|-----------------------------|----------------|---|-------------------|
| Honors 1 st Year | 2017-2018 | 1656×325 | 538200.00 |
| Honors 2 nd Year | 2018-2019 | 1470×325 | 477750.00 |
| Honors 3 rd Year | 2019-2020 | 1440×325 | 468000.00 |
| Honors 4 th Year | 2020-2021 | 1395×325 | 453375.00 |
| Total | | | 1937325.00 |

Table-4

| Class/Year | Session | No. of Students (Tuition & Admission Fees) | Total |
|--------------------|----------------|---|------------------|
| Masters Final Part | 2019-2020 | 1060×390 | 413400.00 |
| Total | | | 413400.00 |

Chapter 6: Concluding Remarks

6.1: Overall Assessment of performance of the Last Year and Key Targets for the Next Year

Due to COVID-19 pandemic situation, overall performance of the college was a bit affected. Yet the teachers and the employees of the college discharged their usual duties and responsibilities using ICT devices in respect of academic and official activities. The college has fixed some targets for the next year to mitigate the loss the students suffered during pandemic situation and carry the academic activities forward smoothly.

- (a) The college has the plan that if the covid-19 situation worsens and physical presence is not allowed, the normal academic and office activities will be carried on the ICT devices.
- (b) With the improvement of Covid-19 situation, classroom-based activities will be increased along with co-curricular activities.

6.2: Key Challenges and Risks for the College

There are obstacles standing in the way to achieving the objectives in due time. Covid 19 pandemic is the main challenge for restoring normal activities of the college.

- Training facilities not yet sufficient.
- The wifi facilities are not yet widely available.
- Lack of awareness of the guardians about their sons and daughters.
- Eve-teasing still exists though not on a large scale.
- The cases of drug abuse on the campus are often heard.

6.3: Recommendations

The college authority recommended some necessary steps for overcoming the challenges.

- More training programmes should be arranged for the teachers to make them able to use computer and ICT device fairly well.
- Curriculum/syllabus should be updated to the International level.
- Enhancing facilities and scopes for research/higher education at college level.
- Expanding transport facilities for the students coming to college from remote areas.
- Providing internet data for the students of financial troubles at nominal cost.
- Proper utilization of limited resources and man power.
- Teaching-friendly atmosphere should be made.
- Improving and modernizing teaching-learning facilities and academic infrastructure.

Chapter 7

Photo Gallery



Renovation and Refurbishment of Library Under CEDP Project





